

European Strut & Support  
M A N U F A C T U R E R



Made in Europe

APPLICATIONS FOR  
**MECHANICAL, HVAC & ELECTRICAL** SYSTEMS  
in building technology for industrial and plant construction

CATALOGUE

2024

# ABOUT US

## Europe Strut&Support Manufacturer

produces a varied line of Strut systems and fittings, along with a complete line of roof hangers, pipe clamps and accessories in a variety of finishes and materials. Our customers have access to one of the most complete support systems across all industries, including metal framing, cable tray supports, pipe hangers and all

types of fasteners.

All of our strut system products are manufactured to meet the highest European industry standards.

Our strut system provides an economical solution for electrical, mechanical and industrial supports, with an unlimited variety of applications in the construction and industry.



### Electrical Applications

- Lighting Fixture Supports
- Raceway Systems
- Trapeze Hangers
- Pipe & Conduit Supports
- Cable Tray Supports
- Beam Adjustments

### Mechanical Applications

- Piping Racks
- Tunnel Pipe Stanchions
- Concrete Inserts
- Beam Attachments
- Pipe Risers

### Industrial Applications

- Racks and Shelving
- Partitions
- Production Line Supports
- Trolley Systems
- Wall Framing

## OUR MISSION

That we are not just a manufacturer, we aim for the best solution to develop and provide the best products, solutions and services that guarantee simple, safe and cost-effective construction.

We do this following the principles of sustainability and ecological responsibility.

# CONTENTS

Strut & C Channels	04-08	1
Cantilever Arms	09-11	2
Heavy Duty Range	12-13	3
Post Base	14-16	4
Flat Fixing	17-19	5
Angle Plate Fixing Bracket	20-24	6
Channel Connector	25-29	7
Beam Clamps	30-32	8
Hanging Systems	33-36	9
Module	37-38	10
Sprinkler	38-39	11
Ventilation	40-41	12
Earth Grounding	41-42	13
Instrument Supports	43-44	14
Framing	45-46	15
Accessories	46-47	16
Special Made	47-48	17
HSEQ	48-49	18
Technical Specifications	50-51	

**ESM offers the universal and complete range of Strut and C channels for a wide range of applications.**

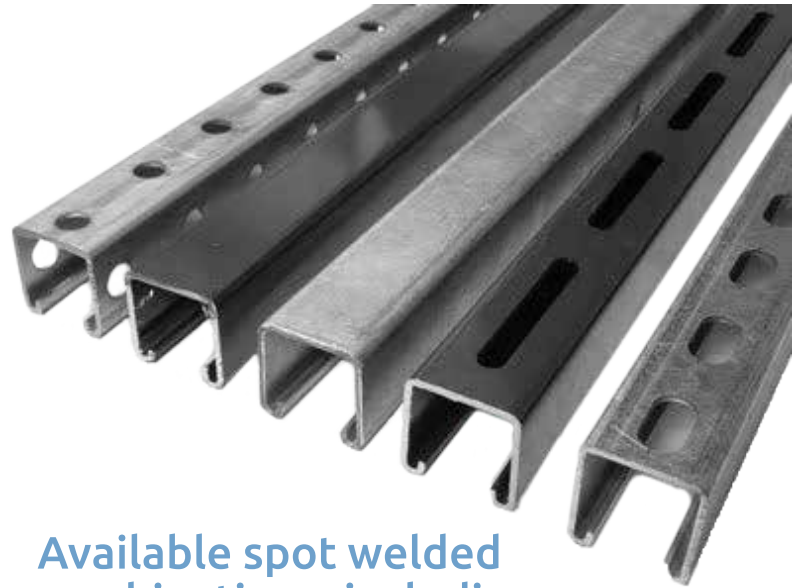

## Available fabrications include:

- Short Slots (SS)
- Long Slots (SL)
- Universal Slots (US)
- Holes (H)

## Available spot welded combinations, including:

- Back-to-Back
- Side-to-Side
- Back-to-Side

Other welded combinations available upon request. These configurations and combinations can be incorporated into any Strut system, including available strut fittings.

”

We cut the channels to your specific lengths and de-burr the edges. We can bundle the cut-to-length Strut and label it for easy customer identification. Various types of material and surface treatments are available. This will ensure that whatever the environment such as marine corrosion atmosphere our pieces are made to last.

From our stock also available untreated black steel version.

## Strut Channel 41x41 - 2.5 Single

1.1

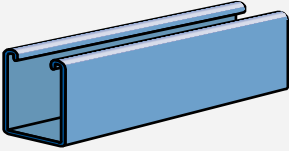
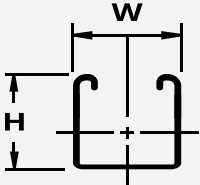
	Dimen- sions	Slot	Lenght in m	Finish BL SG HG SS	Weight (kg/pcs)	Unit	Selling unit	Part no.	
	41x41 - 2.5 -	30x13	1	• • • •	2.67	pieces	100 pcs (1 pcg)	01.4141	
			2	• • • •	5.34			01.4142	
			3	• • • •	8.01			01.4143	
			4	• • • •	10.68			01.4144	
			6	• • • •	16.02			01.4146	

## Strut Channel 41x41 - 2.5 Double

1.2

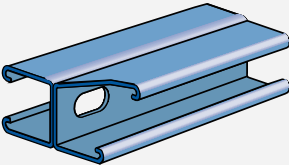
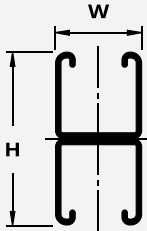
	Dimen- sions	Slot	Lenght in m	Finish BL SG HG SS	Weight (kg/pcs)	Unit	Selling unit	Part no.	
	41x82 - 2.5 -	30x13	1	• • • •	5.34	pieces	100 pcs (1 pcg)	01.4151	
			2	• • • •	10.68			01.4152	
			3	• • • •	16.02			01.4153	
			4	• • • •	21.36			01.4154	
			6	• • • •	32.04			01.4156	

## Strut Channel 41x41 - 2 Single

1.3

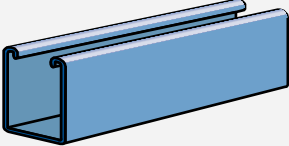
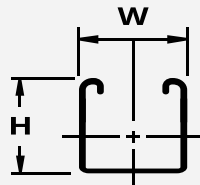
	Dimen- sions	Slot	Lenght in m	Finish BL SG HG SS	Weight (kg/pcs)	Unit	Selling unit	Part no.	
	41x41 - 2 -	30x13	1	• • • •	2.13	pieces	100 pcs (1 pcg)	01.4121	
			2	• • • •	4.26			01.4122	
			3	• • • •	6.39			01.4123	
			4	• • • •	8.52			01.4124	
			6	• • • •	12.78			01.4126	

## Strut Channel 41x41 - 2 Double

1.4

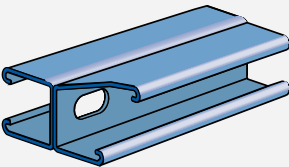
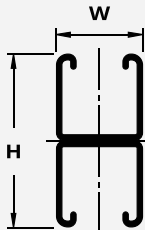
	Dimen- sions	Slot	Lenght in m	Finish BL SG HG SS	Weight (kg/pcs)	Unit	Selling unit	Part no.	
	41x82 - 2 -	30x13	1	• • • •	4.26	pieces	100 pcs (1 pcg)	01.4131	
			2	• • • •	8.52			01.4132	
			3	• • • •	12.78			01.4133	
			4	• • • •	17.04			01.4134	
			6	• • • •	25.56			01.4136	

## Strut Channel 41x41 - 1.5 Single

1.5

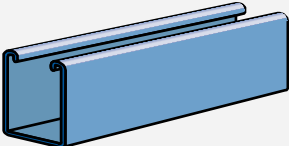
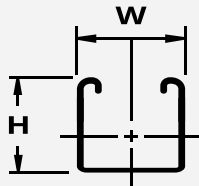
	Dimen- sions	Slot	Lenght in m	Finish BL SG HG SS	Weight (kg/pcs)	Unit	Selling unit	Part no.	
	41x41 - 1.5 -	30x13	1	• • • •	1.65	pieces	100 pcs (1 pcg)	01.4101	
			2	• • • •	3.3			01.4102	
			3	• • • •	4.95			01.4103	
			4	• • • •	6.6			01.4104	
			6	• • • •	9.9			01.4106	

## Strut Channel 41x41 - 1.5 Double

1.6

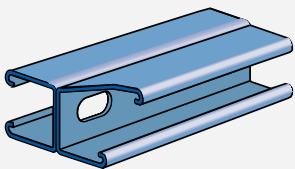
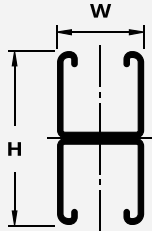
	Dimen- sions	Slot	Lenght in m	Finish BL SG HG SS	Weight (kg/pcs)	Unit	Selling unit	Part no.	
	41x82 - 1.5 -	30x13	1	• • • ○	3.3	pieces	100 pcs (1 pcg)	01.4111	
			2	• • • ○	6.6			01.4112	
			3	• • • ○	9.9			01.4113	
			4	• • • ○	13.2			01.4114	
			6	• • • ○	19.8			01.4116	

## Strut Channel 41x21 - 2.5 Single

1.7

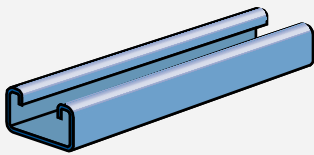
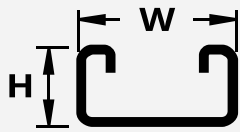
	Dimen- sions	Slot	Lenght in m	Finish BL SG HG SS	Weight (kg/pcs)	Unit	Selling unit	Part no.	
	41x21 - 2.5 -	27x13	1	• • • ○	1.85	pieces	100 pcs (1 pcg)	01.2141	
			2	• • • ○	3.7			01.2142	
			3	• • • ○	5.55			01.2143	
			4	• • • ○	7.4			01.2144	
			6	• • • ○	11.1			01.2146	

## Strut Channel 41x21 - 2.5 Double

1.8

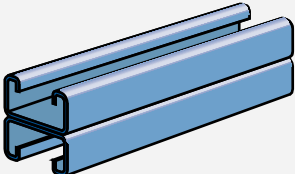
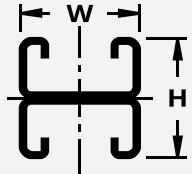
	Dimen- sions	Slot	Lenght in m	Finish BL SG HG SS	Weight (kg/pcs)	Unit	Selling unit	Part no.	
	41x42 - 2.5 -	27x13	1	• • • ○	3.7	pieces	100 pcs (1 pcg)	01.2151	
			2	• • • ○	7.4			01.2152	
			3	• • • ○	11.1			01.2153	
			4	• • • ○	14.8			01.2154	
			6	• • • ○	22.2			01.2156	

## Strut Channel 41x21 - 2 Single

1.9

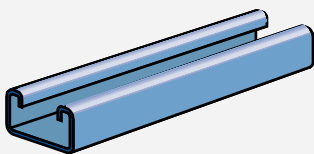
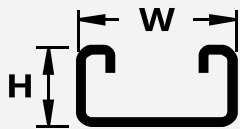
	Dimen- sions	Slot	Lenght in m	Finish BL SG HG SS	Weight (kg/pcs)	Unit	Selling unit	Part no.	
	41x21 - 2 -	27x13	1	• • • ○	1.52	pieces	100 pcs (1 pcg)	01.2121	
			2	• • • ○	3.04			01.2122	
			3	• • • ○	4.56			01.2123	
			4	• • • ○	6.08			01.2124	
			6	• • • ○	9.12			01.2126	

## Strut Channel 41x21 - 2 Double

1.10

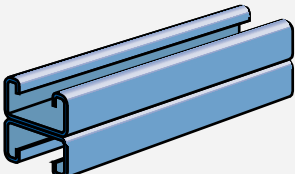
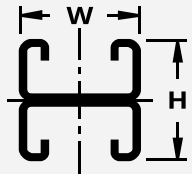
	Dimen- sions	Slot	Lenght in m	Finish BL SG HG SS	Weight (kg/pcs)	Unit	Selling unit	Part no.	
	41x42 - 2 -	27x13	1	• • • ○	3.04	pieces	100 pcs (1 pcg)	01.2131	
			2	• • • ○	6.08			01.2132	
			3	• • • ○	9.12			01.2133	
			4	• • • ○	12.16			01.2134	
			6	• • • ○	18.24			01.2136	

## Strut Channel 41x21 - 1.5 Single

1.11

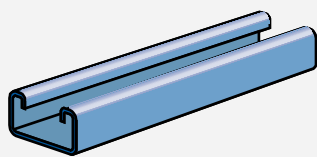

Dimen- sions	Slot	Lenght in m	Finish BL SG HG SS	Weight (kg/pcs)	Unit	Selling unit	Part no.
41x21 - 1.5 -	27x13	1	• • • ○	1.17	pieces	100 pcs (1 pcg)	01.2101
		2	• • • ○	2.34			01.2102
		3	• • • ○	3.51			01.2103
		4	• • • ○	4.68			01.2104
		6	• • • ○	7.02			01.2106

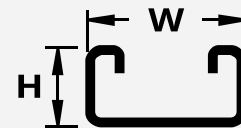

## Strut Channel 41x21 - 1.5 Double

1.12

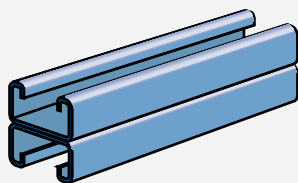

Dimen- sions	Slot	Lenght in m	Finish BL SG HG SS	Weight (kg/pcs)	Unit	Selling unit	Part no.
41x42 - 1.5 -	27x13	1	• • • ○	2.34	pieces	100 pcs (1 pcg)	01.2111.
		2	• • • ○	4.68			01.2112.
		3	• • • ○	7.02			01.2113.
		4	• • • ○	9.36			01.2114
		6	• • • ○	14.04			01.2116

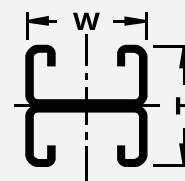

## Strut Channel 41x81 - 2.5 Single

1.13

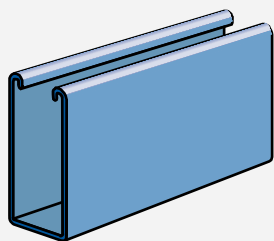

Dimen- sions	Slot	Lenght in m	Finish BL SG HG SS	Weight (kg/pcs)	Unit	Selling unit	Part no.
41x81 - 2.5 -	30x13	1	• • • ○	4.22	pieces	40 pcs (1 pcg)	01.8101
		2	• • • ○	8.44			01.8102
		3	• • • ○	12.66			01.8103
		4	• • • ○	16.88			01.8104
		6	• • • ○	25.32			01.8106

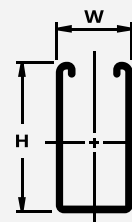

## Strut Channel 41x81 - 2.5 Double

1.14

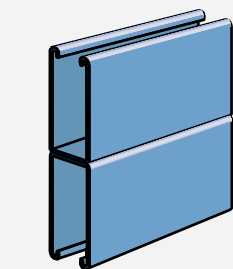

Dimen- sions	Slot	Lenght in m	Finish BL SG HG SS	Weight (kg/pcs)	Unit	Selling unit	Part no.
41x162 - 2.5 -	30x13	1	• • • ○	8.44	pieces	40 pcs (1 pcg)	01.8111
		2	• • • ○	16.88			01.8112
		3	• • • ○	25.32			01.8113
		4	• • • ○	33.76			01.8114
		6	• • • ○	50.64			01.8116



## Strut Channel 41x61 - 2.5 Single

1.15

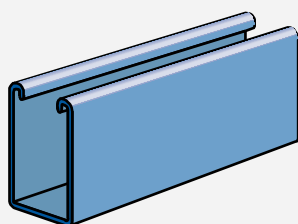

Dimen- sions	Slot	Lenght in m	Finish BL SG HG SS	Weight (kg/pcs)	Unit	Selling unit	Part no.
41x61 - 2.5 -	30x13	1	• • • ○	3.44	pieces	50 pcs (1 pcg)	01.6101
		2	• • • ○	6.88			01.6102
		3	• • • ○	10.32			01.6103
		4	• • • ○	13.76			01.6104
		6	• • • ○	20.64			01.6106

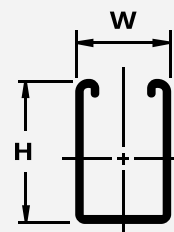

## Strut Channel 41x61 - 2.5 Double

1.16

	Dimen- sions	Slot	Lenght in m	Finish BL SG HG SS	Weight (kg/pcs)	Unit	Selling unit	Part no.	
	41x61 - 2.5 -	30x13	1	• • • ○	6.88	pieces	50 pcs (1 pcg)	01.6111	
			2	• • • ○	13.76			01.6112	
			3	• • • ○	20.64			01.6113	
			4	• • • ○	27.52			01.6114	
			6	• • • ○	41.28			01.6116	

## C Channel 27x18 - 1.25 Single

1.17

	Dimen- sions	Slot	Lenght in m	Finish BL SG HG SS	Weight (kg/pcs)	Unit	Selling unit	Part no.	
	27x18 - 1.25 -	30x13	1	• • • ○	0.65	pieces	100 pcs (1 pcg)	01.1801	
			2	• • • ○	1.3			01.1802	
			3	• • • ○	1.95			01.1803	
			4	• • • ○	2.6			01.1804	
			6	• • • ○	3.9			01.1806	

## C Channel 27x30 - 1.5 Single

1.18

	Dimen- sions	Slot	Lenght in m	Finish BL SG HG SS	Weight (kg/pcs)	Unit	Selling unit	Part no.	
	27x30 - 1.5 -	30x13	1	• • ○ ○	1.04	pieces	100 pcs (1 pcg)	01.3001	
			2	• • ○ ○	2.08			01.3002	
			3	• • ○ ○	3.12			01.3003	
			4	• • ○ ○	4.16			01.3004	
			6	• • ○ ○	6.24			01.3006	

## C Channel 38x40 - 2 Single

1.19

	Dimen- sions	Slot	Lenght in m	Finish BL SG HG SS	Weight (kg/pcs)	Unit	Selling unit	Part no.	
	38x40 - 2 -	30x13	1	• • ○ ○	1.97	pieces	50 pcs (1 pcg)	01.4001	
			2	• • ○ ○	3.94			01.4002	
			3	• • ○ ○	5.91			01.4003	
			4	• • ○ ○	7.88			01.4004	
			6	• • ○ ○	11.82			01.4006	

## C Channel 35x35 - 2 Single

1.20

	Dimen- sions	Slot Hole	Lenght in m	Finish BL SG HG SS	Weight (kg/pcs)	Unit	Selling unit	Part no.	
	35x35 - 2 -	27x11 + 3.5x3.5	1	• • ○ ○	1.79	pieces	50 pcs (1 pcg)	01.3501	
			2	• • ○ ○	3.58			01.3502	
			3	• • ○ ○	5.37			01.3503	
			4	• • ○ ○	7.16			01.3504	
			6	• • ○ ○	10.74			01.3505	

**ESM** manufactures various Cantilever arms, in different designs and shapes:

light  
standard  
heavy duty versions  
tailored to customers specification

## WE MANUFACTURE:

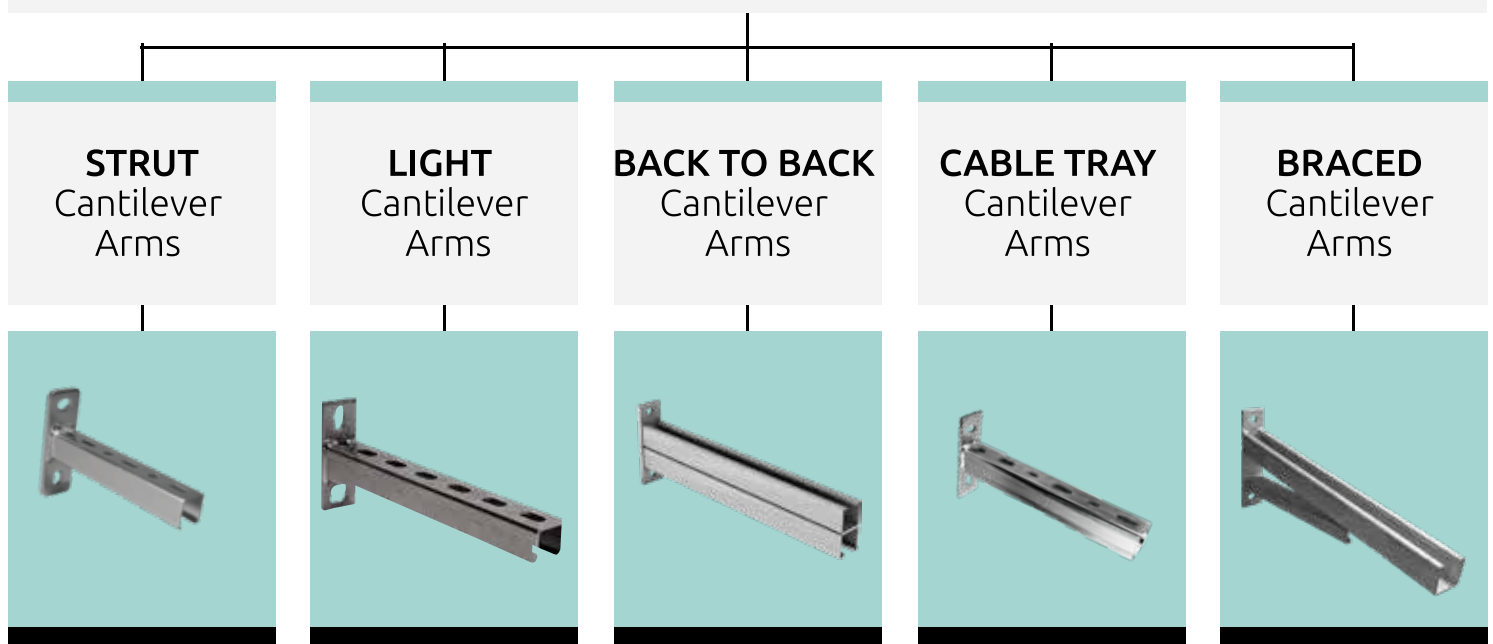

... in various surface finish as well in stainless steel.

The Cantilevers arms do not need to be cut to size because we offer a wide range of lengths and as manufacturer we can produce the Cantilever Arms by customer requirements, back plate channel lengths as well the slot holes.

”

As manufacturer's  
we can produce in different materials, thicknesses, lengths;  
with or without finish...

**We can design and produce custom solutions!**

## Cantilever standard arm 41x41 -2.5

## 2.1

	Channel	Length in m	Back plate		Packing	Weight (kg/pcs)	Part no.	Finish			
			WxHxT	Slot				BL	SG	HG	SS
	41x41 - 2.5 -	150	133x50x8	27x14	20	0.72	<b>02.4101</b>	•	•	•	•
		200			20	0.85	<b>02.4102</b>				
		300			10	1.09	<b>02.4103</b>				
		450			5	1.45	<b>02.4104</b>				
		500			5	1.54	<b>02.4105</b>				
		600			1	1.79	<b>02.4106</b>				
		750			1	2.16	<b>02.4107</b>				
		1000			1	2.83	<b>02.4108</b>				
		1200			1	3.55	<b>02.4109</b>				
		1500			1	4.03	<b>02.4110</b>				
		2000			1	5.61	<b>02.4111</b>				

## Cantilever arm light 41x41 - 2

## 2.2

	Channel	Length in m	Back plate		Packing	Weight (kg/pcs)	Part no. 1	Finish			
			WxHxT	Slot				BL	SG	HG	SS
	41x41 - 2 -	150	125x45x6	27x14	20	0.58	<b>02.4112</b>	•	•	•	○
		200			20	0.71	<b>02.4113</b>				
		300			10	0.89	<b>02.4114</b>				
		450			5	1.23	<b>02.4115</b>				
		500			5	1.29	<b>02.4116</b>				
		600			1	1.51	<b>02.4117</b>				
		750			1	1.87	<b>02.4118</b>				
		1000			1	2.52	<b>02.4119</b>				
		1200			1	3.23	<b>02.41110</b>				
		1500			1	3.67	<b>02.41111</b>				
		2000			1	5.13	<b>02.41112</b>				

## Cantilever arm 41x21 - 2.5

## 2.3

	Channel	Lenght in m	Back plate		Packing	Weight (kg/pcs)	Part no. 1	Finish			
			WxHxT	Slot				BL	SG	HG	SS
	41x21 - 2.5 -	150	133x50x8	27x14	20	0.6	02.2101	●	●	●	○
		300			10	0.86	02.2102				
		450			5	1.11	02.2103				

## Cantilever arm 41x21-2.5 Double

2.4



Channel	Lenght in m	Back plate WxHxT Slot	Packing	Weight (kg/pcs)	Part no.	Finish BL SG HG SS
41x42 - 2.5 - (Back to back)	300	133x50x8 27x14	10	1.4	<b>02.2121</b>	● ● ● ○
	450		5	1.9	<b>02.2122</b>	
	600		1	2.5	<b>02.2123</b>	
	750		1	2.96	<b>02.2124</b>	

## Cantilever arm 27x30 -1.5

2.5



Channel	Lenght in m	Back plate WxHxT Slot	Packing	Weight (kg/pcs)	Part no.	Finish BL SG HG SS
27x30 - 1.5 -	180	120x45x6 18x11	25	0.41	<b>02.3001</b>	● ● ○ ○
	240		25	0.48	<b>02.3002</b>	
	300		25	0.48	<b>02.3003</b>	
	360		25	0.59	<b>02.3004</b>	
	420		10	0.66	<b>02.3005</b>	
	540		1	0.78	<b>02.3006</b>	
	660		1	0.9	<b>02.3007</b>	
	780		1	1.02	<b>02.3008</b>	

## Cantilever arm 27x18 - 1.25

2.6



Channel	Lenght in m	Back plate WxHxT Slot	Packing	Weight (kg/pcs)	Part no.	Finish BL SG HG SS
27x18 - 1.25 -	180	120x45x4 18x11	25	0.27	<b>02.1801</b>	● ● ○ ○
	300		25	0.35	<b>02.1802</b>	

## European Strut & Support Manufacturer

is manufacturing a wide range of Heavy Duty Cantilevers for supporting of pipelines or conduits in industrial installations.

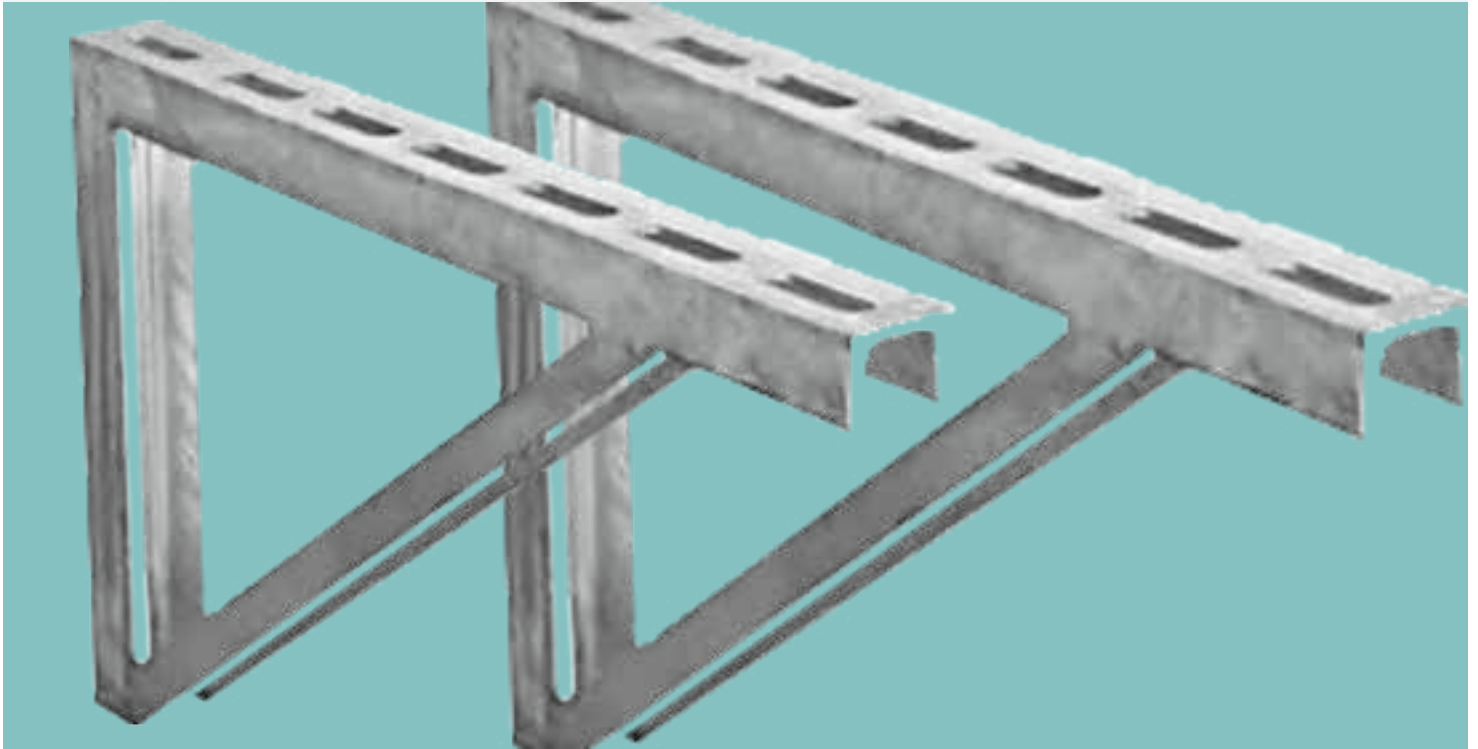

”

### As manufacturer's

we can produce in different materials, thicknesses, lengths; with or without finish...

**We can design and produce custom solutions!**

## Heavy Duty Arm 300x200

### 3.1

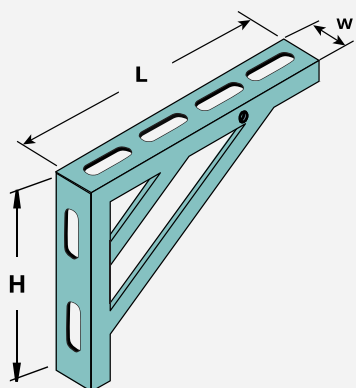

Profile	Height	Lenght in mm	Slot	Packing	Weight (kg/pcs)	Part no. 1	Finish BL SG HG SS			
UNP 50x25x5	240	315	57.5x17.5	1	2.26	03.0001	•	•	•	•

## Heavy Duty Arm 550x350

### 3.2

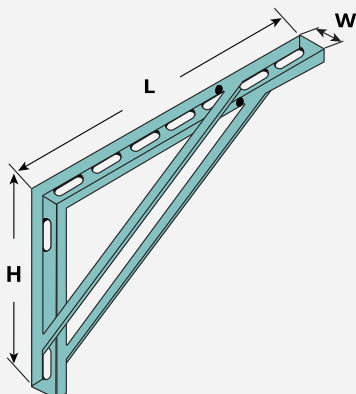

Profile	Height	Lenght in mm	Slot	Packing	Weight (kg/pcs)	Part no. 1	Finish BL SG HG SS			
UNP 50x25x5	350	550	57.5x17.5	1	3.87	03.0002	•	•	•	•

## Heavy Duty Cantilever Arm 300x200

### 3.3

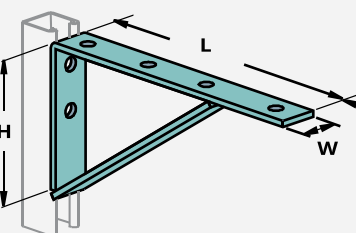

Flat strip	Height	Lenght in mm	Slot	Packing	Weight (kg/pcs)	Part no. 1	Finish BL SG HG SS			
40x6	200	300	57.5x17.5	1	0.96	03.0003	•	•	•	•

**Post Bases** are designed to fit with all Strut channels and double channels. We can also make customized post bases for square and rectangular tubes, or for any kind of profiles and beams.

All Post Bases are manufactured from 4,5 or 6 mm thick carbon steel and are available in a variety of finishes.

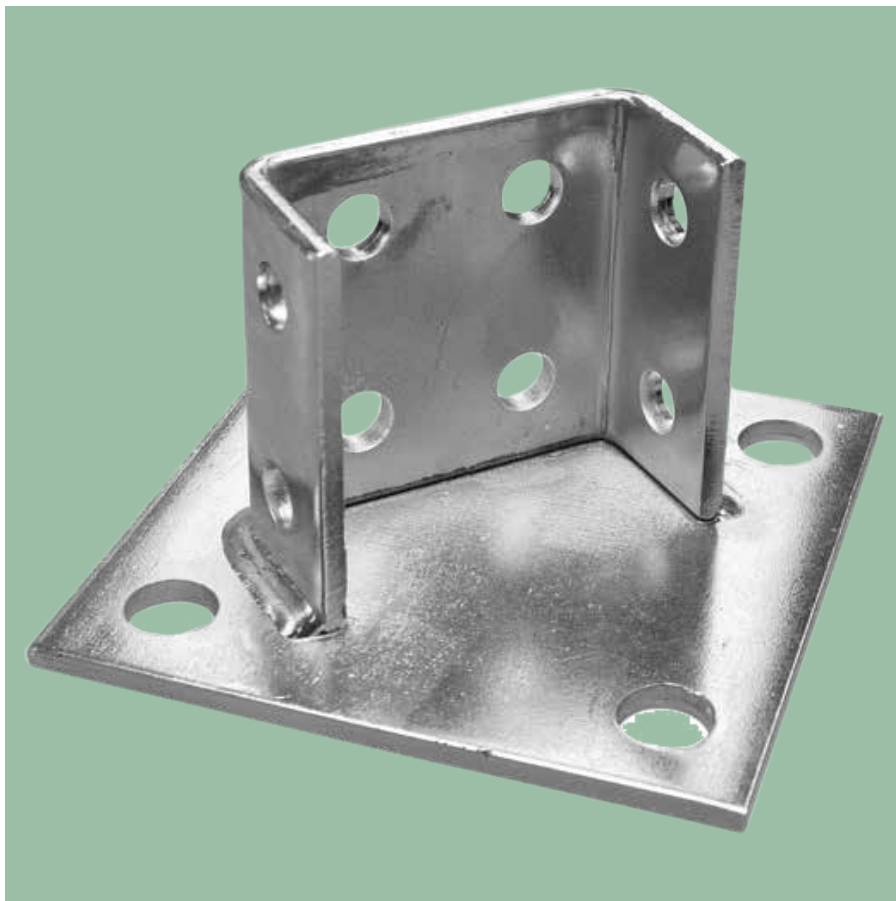

”

**As manufacturer's**

we can produce in different materials, thicknesses, lengths; with or without finish...

**We can design and produce custom solutions!**

## Post base 100x100x50; Single 41

### 4.1

	Dimensions				Hole	Packing	Weight (kg/pcs)	Part no. 1	Finish			
	W	L	H	T					BL	SG	HG	SS
	100	100	50	4 6					•	•	•	•
					Ø13	25	0.40 0.61	<b>04.4001</b> <b>04.6001</b>	•	•	•	○

## Post base 100x100x40; Single 41

### 4.2

	Dimensions				Hole	Packing	Weight (kg/pcs)	Part no. 1	Finish			
	W	L	H	T					BL	SG	HG	SS
	100	100	40	4 6					•	•	•	•
					Ø13	25	0.42 0.63	<b>04.4002</b> <b>04.6002</b>	•	•	•	○

## Post base 200x100x40; Double 41

### 4.3

	Dimensions				Hole	Packing	Weight (kg/pcs)	Part no. 1	Finish			
	W	L	H	T					BL	SG	HG	SS
	200	100	40	4 6					•	•	•	•
					Ø13	10	1.04 1.25	<b>04.4003</b> <b>04.6003</b>	•	•	•	○

## Post base 215x45x150; Single 41 - Open

### 4.4

	Dimensions				Hole	Packing	Weight (kg/pcs)	Part no. 1	Finish			
	W	L	H	T					BL	SG	HG	SS
	150	215	45	4 6					•	•	•	•
					Ø13	8	1.45 1.66	<b>04.4004</b> <b>04.6004</b>	•	•	•	○

## Post base 255x45x150; Single 41 - Open

### 4.5

	Dimensions				Hole	Packing	Weight (kg/pcs)	Part no. 1	Finish			
	W	L	H	T					BL	SG	HG	SS
	150	255	45	4 6					•	•	•	•
					Ø13	1	1.78 1.99	<b>04.4005</b> <b>04.6005</b>	•	•	•	○

## Post base 100x100x40; Single 41 - Corner

### 4.6

	Dimensions				Hole	Packing	Weight (kg/pcs)	Part no. 1	Finish			
	W	L	H	T					BL	SG	HG	SS
	100	100	40	4 6					•	•	•	•
					Ø13	4	0.62	<b>04.4006</b> <b>04.6006</b>	•	•	•	○

## Post base 150x150x100; Single 41

4.7

	Dimensions				Hole	Packing	Weight (kg/pcs)	Part no. 1	Finish			
	W	L	H	T					BL	SG	HG	SS
	150	150	100	4 6					•	•	•	•
					Ø13	8	1.45 1.66	<b>04.4007</b> <b>04.6007</b>	•	•	•	○

## Post base 150x150x100; Double 41 - Angle 45

4.8

	Dimensions				Hole	Packing	Weight (kg/pcs)	Part no. 1	Finish			
	W	L	H	T					BL	SG	HG	SS
	150	150	100	4 6					•	•	•	•
					Ø13	1	1.58 1.79	<b>04.4008</b> <b>04.6008</b>	•	•	•	○

## Post base 150x150x100; Double 41

4.9

	Dimensions				Hole	Packing	Weight (kg/pcs)	Part no. 1	Finish			
	W	L	H	T					BL	SG	HG	SS
	150	150	100	4 6					•	•	•	•
					Ø13	8	1.65 1.86	<b>04.4009</b> <b>04.6009</b>	•	•	•	○

## Post base Low 250x55x105; Single 41

4.11

	Dimensions				Hole	Packing	Weight (kg/pcs)	Part no. 1	Finish			
	W	L	H	T					BL	SG	HG	SS
	250	55	105	4 6					•	•	•	•
					Ø13	8	1.67 1.88	<b>04.4011</b> <b>04.6011</b>	•	•	•	○

## Post base Rectangular 80x160x100; Single 41

4.12

	Dimensions				Hole	Packing	Weight (kg/pcs)	Part no. 1	Finish			
	W	L	H	T					BL	SG	HG	SS
	80	160	100	4 6					•	•	•	•
					Ø13	1	0.99 1.20	<b>04.4012</b> <b>04.6012</b>	•	•	•	○

This section offers a wide range of fittings and accessories to complete our Strut channel system.

Flat fixing brackets are suitable for the construction of the channel systems. The connectors are offered as flat plate or angle fittings with formed holes or slot for connecting the mounting channel.

The fittings can be offered in 4, 5 or 6 mm and are available in a variety of finishes as well in stainless steel.



“

**AS MANUFACTURER'S  
WE CAN PRODUCE IN DIFFERENT MATERIALS,  
THICKNESSES, LENGTHS;  
WITH OR WITHOUT FINISH;  
WE CAN DESIGN AND PRODUCE CUSTOM SOLUTIONS!**

”

## Flat fixing 90x136 - 4 holes

### 5.1

	W	Dimensions		Hole	Nr. of holes	Packing	Weight (kg/pcs)	Part no. 1	Finish			
		L	T						BL	SG	HG	SS
	90	136	4	Ø13	4	10	0.30	<b>05.4001</b>	•	•	•	•
			6				0.46	<b>05.6001</b>	•	•	•	•

## Flat fixing 40x40 - 1 hole

### 5.2

	W	Dimensions		Hole	Nr. of holes	Packing	Weight (kg/pcs)	Part no. 1	Finish			
		L	T						BL	SG	HG	SS
	40	40	4	Ø13	1	25	0.05	<b>05.4002</b>	•	•	•	•
			6				0.07	<b>05.6002</b>	•	•	•	•

## Flat fixing 40x30 - 1 hole

### 5.3

	W	Dimensions		Hole	Nr. of holes	Packing	Weight (kg/pcs)	Part no. 1	Finish			
		L	T						BL	SG	HG	SS
	40	30	4	Ø13	1	25	0.03	<b>05.4003</b>	•	•	•	•
			6				0.05	<b>05.6003</b>	•	•	•	•

## Flat fixing 40x88 - 2 holes

### 5.4

	W	Dimensions		Hole	Nr. of holes	Packing	Weight (kg/pcs)	Part no. 1	Finish			
		L	T						BL	SG	HG	SS
	40	80	4	Ø13	2	25	0.10	<b>05.4004</b>	•	•	•	•
			6				0.15	<b>05.6004</b>	•	•	•	•

## Flat fixing 40x136 - 3 holes

### 5.5

	W	Dimensions		Hole	Nr. of holes	Packing	Weight (kg/pcs)	Part no. 1	Finish			
		L	T						BL	SG	HG	SS
	40	136	4	Ø13	3	25	0.17	<b>05.4005</b>	•	•	•	•
			6				0.24	<b>05.6005</b>	•	•	•	•

## Flat fixing 40x168 - 4 holes

### 5.6

	W	Dimensions		Hole	Nr. of holes	Packing	Weight (kg/pcs)	Part no. 1	Finish			
		L	T						BL	SG	HG	SS
	40	168	4	Ø13	4	10	0.21	<b>05.4006</b>	•	•	•	•
			6				0.31	<b>05.6006</b>	•	•	•	•

## Flat fixing 40x232 - 5 holes

5.7

	Dimensions				Nr. of holes	Packing	Weight (kg/pcs)	Part no. 1	Finish			
	W	L	T	Hole					BL	SG	HG	SS
	40	235	4 6	Ø13	5	10	0.273 0.39	<b>05.4007</b> <b>05.6007</b>	• • • •	• • • •		

## Flat fixing 40x164 - 3 holes

5.8

	Dimensions				Nr. of holes	Packing	Weight (kg/pcs)	Part no. 1	Finish			
	W	L	T	Hole					BL	SG	HG	SS
	40	164	4 6	Ø13	3	25	2.02 2.89	<b>05.4008</b> <b>05.6008</b>	• • • •	• • • •		

## Flat fixing G 90x90 - 3 holes

5.9

	Dimensions				Nr. of holes	Packing	Weight (kg/pcs)	Part no. 1	Finish			
	W	L	T	Hole					BL	SG	HG	SS
	90	90	4 6	Ø13	3	25	0.17 0.24	<b>05.4009</b> <b>05.6009</b>	• • • •	• • • •		

## Flat fixing T 139x90 - 4 holes

5.10

	Dimensions				Nr. of holes	Packing	Weight (kg/pcs)	Part no. 1	Finish			
	W	L	T	Hole					BL	SG	HG	SS
	139	90	4 6	Ø13	4	25	0.30 0.42	<b>05.4010</b> <b>05.6010</b>	• • • •	• • • •		

## Flat fixing 138x138 - 5 holes

5.11

	Dimensions				Nr. of holes	Packing	Weight (kg/pcs)	Part no. 1	Finish			
	W	L	T	Hole					BL	SG	HG	SS
	138	138	4 6	Ø13	5	10	0.30 0.43	<b>05.4011</b> <b>05.6011</b>	• • • •	• • • •		



”

This section offers a wide range of fittings and accessories to complete our strut channel system. Fittings brackets are suitable for the construction of the channel systems. The connectors are offered as flat plate or angle fittings with formed holes or slot for connecting the mounting channel. The fittings can be offered in 4, 5 or 6 mm and are available in a variety of finishes as well in stainless steel.

**As manufacturer's**

we can produce in different materials, thicknesses, lengths; with or without finish; is no problem.

**We can design and produce custom solutions!**

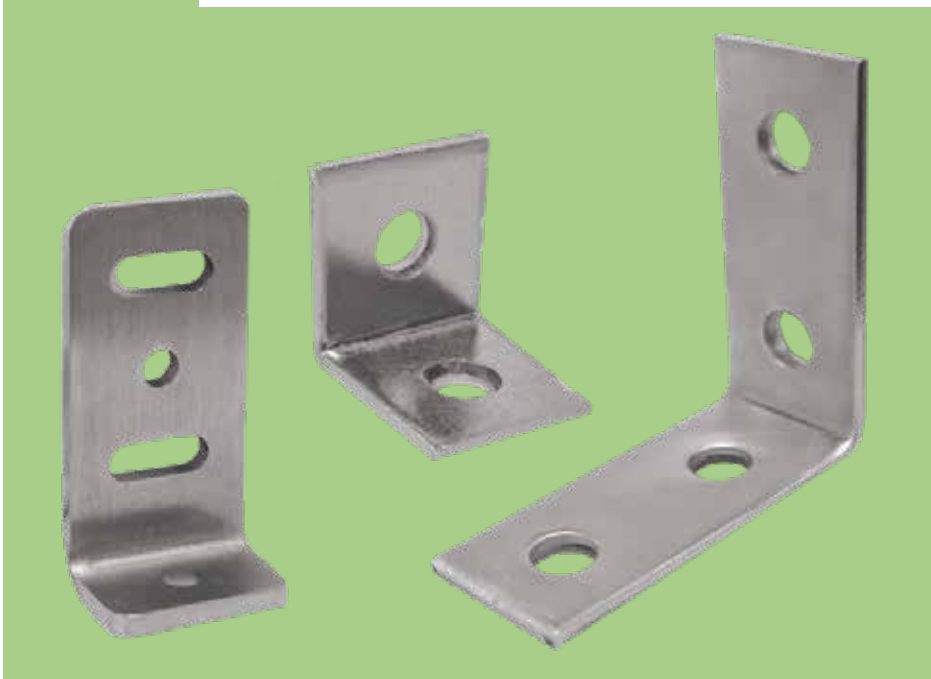

## Angle fixing 50/48-90 - 1-1 hole

### 6.1

	Dimensions					Nr. of holes	Packing	Weight (kg/pcs)	Part no. 1	Finish			
	W	L	H	T	Hole					BL	SG	HG	SS
	40	50	48	4 6	Ø13	2	10	0.10 0.15	<b>06.4001</b> <b>06.6001</b>	•	•	•	•

## Angle fixing 58/42-90 - 1-1 hole

### 6.2

	Dimensions					Nr. of holes	Packing	Weight (kg/pcs)	Part no. 1	Finish			
	W	L	H	T	Hole					BL	SG	HG	SS
	40	58	42	4 6	Ø13	2	10	0.10 0.15	<b>06.4002</b> <b>06.6002</b>	•	•	•	•

## Angle fixing 103/42-90 - 1-2 hole

### 6.3

	Dimensions					Nr. of holes	Packing	Weight (kg/pcs)	Part no. 1	Finish			
	W	L	H	T	Hole					BL	SG	HG	SS
	40	103	42	4 6	Ø13	3	10	0.16 0.23	<b>06.4003</b> <b>06.6003</b>	•	•	•	•

## Angle fixing 99/47-90 - 1-2 hole

### 6.4

	Dimensions					Nr. of holes	Packing	Weight (kg/pcs)	Part no. 1	Finish			
	W	L	H	T	Hole					BL	SG	HG	SS
	40	99	47	4 6	Ø13	3	10	0.16 0.23	<b>06.4004</b> <b>06.6004</b>	•	•	•	•

## Angle fixing 89/57-90 - 1-2 hole

### 6.5

	Dimensions					Nr. of holes	Packing	Weight (kg/pcs)	Part no. 1	Finish			
	W	L	H	T	Hole					BL	SG	HG	SS
	40	89	57	4 6	Ø13	3	10	0.16 0.24	<b>06.4005</b> <b>06.6005</b>	•	•	•	•

## Angle fixing 102/86-90 - 2-2 hole

### 6.6

	Dimensions					Nr. of holes	Packing	Weight (kg/pcs)	Part no. 1	Finish			
	W	L	H	T	Hole					BL	SG	HG	SS
	40	102	86	4 6	Ø13	4	10	0.16 0.32	<b>06.4006</b> <b>06.6006</b>	•	•	•	•

## Angle fixing 132/56-90 - 1-3 hole

6.7

	Dimensions					Nr. of holes	Packing	Weight (kg/pcs)	Part no. 1	Finish			
	W	L	H	T	Hole					BL	SG	HG	SS
	40	132	56	4 6	Ø13	4	10	0.22 0.32	<b>06.4007</b> <b>06.6007</b>	• • • •	• • • •	• • • •	• • • •

## Angle fixing 106/89-90 - 2-2 hole

6.8

	Dimensions					Nr. of holes	Packing	Weight (kg/pcs)	Part no. 1	Finish			
	W	L	H	T	Hole					BL	SG	HG	SS
	43	106	89	4 6	Ø13	4	1	0.29 0.42	<b>06.4008</b> <b>06.6008</b>	• • • •	• • • •	• • • •	• • • •

## Angle fixing L 106/89-90 - 2-2 hole

6.9

	Dimensions					Nr. of holes	Packing	Weight (kg/pcs)	Part no. 1	Finish			
	W	L	H	T	Hole					BL	SG	HG	SS
	43	106	89	4 6	Ø13	4	1	0.29 0.42	<b>06.4009</b> <b>06.6009</b>	• • • •	• • • •	• • • •	• • • •

## Angle fixing 105/90-90 - 2-2 hole

6.10

	Dimensions					Nr. of holes	Packing	Weight (kg/pcs)	Part no. 1	Finish			
	W	L	H	T	Hole					BL	SG	HG	SS
	90	105	45	4 6	Ø13	4	1	0.31 0.45	<b>06.4010</b> <b>06.6010</b>	• • • •	• • • •	• • • •	• • • •

## Angle fixing 100/136-90 - 2-2 hole

6.11

	Dimensions					Nr. of holes	Packing	Weight (kg/pcs)	Part no. 1	Finish			
	W	L	H	T	Hole					BL	SG	HG	SS
	100	136	45	4 6	Ø13	4	1	0.40 0.57	<b>06.4011</b> <b>06.6011</b>	• • • •	• • • •	• • • •	• • • •

## Angle fixing T-M 52/136-90 - 3-1 hole

6.12

	Dimensions					Nr. of holes	Packing	Weight (kg/pcs)	Part no. 1	Finish			
	W	L	H	T	Hole					BL	SG	HG	SS
	45	136	52	4 6	Ø13	4	1	0.24 0.34	<b>06.4012</b> <b>06.6012</b>	• • • •	• • • •	• • • •	• • • •

## Angle fixing T-R 50/90-90 - 3-1 hole

6.13

	Dimensions					Nr. of holes	Packing	Weight (kg/pcs)	Part no. 1	Finish			
	W	L	H	T	Hole					BL	SG	HG	SS
	50	95	90	4 6	Ø13	4	5	0.22 0.32	06.4013 06.6013	•	•	•	•



## Angle fixing T-L 50/90-90 - 3-1 hole

6.14

	Dimensions					Nr. of holes	Packing	Weight (kg/pcs)	Part no. 1	Finish			
	W	L	H	T	Hole					BL	SG	HG	SS
	50	95	90	4 6	Ø13	4	5	0.24 0.34	06.4014 06.6014	•	•	•	•



## Angle fixing G-R 50/90-90 - 1-2 hole

6.15

	Dimensions					Nr. of holes	Packing	Weight (kg/pcs)	Part no. 1	Finish			
	W	L	H	T	Hole					BL	SG	HG	SS
	45	90	50	4 6	Ø13	3	5	0.17 0.25	06.4015 06.6015	•	•	•	•



## Angle fixing G-L 50/90-90 - 1-2 hole

6.16

	Dimensions					Nr. of holes	Packing	Weight (kg/pcs)	Part no. 1	Finish			
	W	L	H	T	Hole					BL	SG	HG	SS
	45	90	50	4 6	Ø13	3	5	0.17 0.25	06.4016 06.6016	•	•	•	•



## Angle fixing 53/78-45 - 1-1 hole

6.17

	Dimensions					Nr. of holes	Packing	Weight (kg/pcs)	Part no. 1	Finish			
	W	L	H	T	Hole					BL	SG	HG	SS
	40	78	53	4 6	Ø13	2	5	0.17 0.24	06.4017 06.6017	•	•	•	•



## Angle fixing 87/87-45 - 2-2 hole

6.18

	Dimensions					Nr. of holes	Packing	Weight (kg/pcs)	Part no. 1	Finish			
	W	L	H	T	Hole					BL	SG	HG	SS
	50	87	87	4	Ø13	4	5	0.21	<b>06.4018</b>	•	•	•	•
				6				0.32					
									<b>06.6018</b>	•	•	•	•

## Angle brace 300/300-45 -1-1 hole

6.19

	Dimensions					Nr. of holes	Packing	Weight (kg/pcs)	Part no. 1	Finish			
	W	L	H	T	Hole					BL	SG	HG	SS
	40	368	368	4	Ø13	4	1	0.51	<b>06.4019</b>	•	•	•	•
				6				0.73					
									<b>06.6019</b>	•	•	•	•

## Angle brace 200/200-45 - 1-1 holes

6.20

	Dimensions					Nr. of holes	Packing	Weight (kg/pcs)	Part no. 1	Finish			
	W	L	H	T	Hole					BL	SG	HG	SS
	40	218	218	4	Ø13	2	1	0.38	<b>06.4020</b>	•	•	•	•
				6				0.55					
									<b>06.6020</b>	•	•	•	•

## Angle brace 500/500-45 - 1-1 holes

6.21

	Dimensions					Nr. of holes	Packing	Weight (kg/pcs)	Part no. 1	Finish			
	W	L	H	T	Hole					BL	SG	HG	SS
	40	651	651	4	Ø13	2	1	0.98	<b>06.4021</b>	•	•	•	•
				6				1.4					
									<b>06.6021</b>	•	•	•	•

**Channel connectors** are designed to fasten to or join together longitudinal sections of all strut channels.

The channel connectors are made of 4mm or 6 mm steel and finished with hot dip galvanized or zinc plated steel to handle high compression loads.



”

**As manufacturer's** we can produce in different materials, thicknesses, lengths; with or without finish; is no problem.

**We can design and produce custom solutions!**

## Channel connector 90° 41x41 - 3 holes

7.1

	Dimensions			Nr. of holes	Packing	Weight (kg/pcs)	Part no. 1	Finish			
	Profile	T	Hole					BL	SG	HG	SS
	41x41	4 6	Ø13	3	5	0.20 0.29	<b>07.4001</b> <b>07.6001</b>	• •	• •	• •	• •

## Channel connector 90° 41x21 - 3 holes

7.2

	Dimensions			Nr. of holes	Packing	Weight (kg/pcs)	Part no. 1	Finish			
	Profile	T	Hole					BL	SG	HG	SS
	41x21	4 6	Ø13	3	5	0.29 0.42	<b>07.4002</b> <b>07.6002</b>	• •	• •	• •	• •

## Channel connector 90° 41x41 Side to side - 6 holes

7.3

	Dimensions			Nr. of holes	Packing	Weight (kg/pcs)	Part no. 1	Finish			
	Profile	T	Hole					BL	SG	HG	SS
	41x41	4 6	Ø13	6	5	0.30 0.43	<b>07.4003</b> <b>07.6003</b>	• •	• •	• •	• •

## Channel connector 90° 41x41 Back to back - 3 holes

7.4

	Dimensions			Nr. of holes	Packing	Weight (kg/pcs)	Part no. 1	Finish			
	Profile	T	Hole					BL	SG	HG	SS
	41x41	4 6	Ø13	3	5	0.37 0.53	<b>07.4004</b> <b>07.6004</b>	• •	• •	• •	• •

## Channel connector Inside 41x21 - 4 holes

7.5

	Dimensions			Nr. of holes	Packing	Weight (kg/pcs)	Part no. 1	Finish			
	Profile	T	Hole					BL	SG	HG	SS
	41x21	2	Ø13	4	5	0.23	<b>07.2005</b>	•	•	•	•

## Channel connector Inside 41x41 - 4 holes

7.6

	Dimensions			Nr. of holes	Packing	Weight (kg/pcs)	Part no. 1	Finish			
	Profile	T	Hole					BL	SG	HG	SS
	41x41	2.5	Ø13	4	5	0.46	<b>07.2006</b>	•	•	•	•

## Channel connector Outside 41x21 - 4 holes

7.7

	Dimensions			Nr. of holes	Packing	Weight (kg/pcs)	Part no. 1	Finish			
	Profile	T	Hole					BL	SG	HG	SS
	41x21	4 6	Ø13	4	5	0.49 0.71	<b>07.4007</b> <b>07.6007</b>	•	•	•	•

## Channel connector Outside 41x41 - 4 holes

7.8

	Dimensions			Nr. of holes	Packing	Weight (kg/pcs)	Part no. 1	Finish			
	Profile	T	Hole					BL	SG	HG	SS
	41x41	4 6	Ø13	4	5	0.74 1.06	<b>07.4008</b> <b>07.6008</b>	•	•	•	•

## Channel connector M12 Inside 41 - 4 holes

7.9

	Dimensions			Nr. of holes	Packing	Weight (kg/pcs)	Part no. 1	Finish			
	Profile	T	Hole					BL	SG	HG	SS
	41x41 & 41x41	5 10	M12	4	5	0.26 0.53	<b>07.5009</b> <b>07.1009</b>	•	•	•	○

## Channel connector Z-shaped 41x21 - 2 holes

7.10

	Dimensions			Nr. of holes	Packing	Weight (kg/pcs)	Part no. 1	Finish			
	Profile	T	Hole					BL	SG	HG	SS
	41x21	4 6	Ø13	2	10	0.13 0.18	<b>07.4010</b> <b>07.6010</b>	• •	• •	• •	• •

## Channel connector Z-shaped 41x41 - 2 holes

7.11

	Dimensions			Nr. of holes	Packing	Weight (kg/pcs)	Part no. 1	Finish			
	Profile	T	Hole					BL	SG	HG	SS
	41x41	4 6	Ø13	2	10	0.15 0.22	<b>07.4011</b> <b>07.6011</b>	• •	• •	• •	• •

## Channel connector Z-shaped 41x81; 3 holes

7.12

	Dimensions			Nr. of holes	Packing	Weight (kg/pcs)	Part no. 1	Finish			
	Profile	T	Hole					BL	SG	HG	SS
	41x81	4 6	Ø13	3	10	0.19 0.28	<b>07.4012</b> <b>07.6012</b>	• •	• •	• •	• •

## Channel connector Z-shaped 41x41 - 3 holes

7.13

	Dimensions			Nr. of holes	Packing	Weight (kg/pcs)	Part no. 1	Finish			
	Profile	T	Hole					BL	SG	HG	SS
	41x41	4 6	Ø13	3	10	0.15 0.21	<b>07.4013</b> <b>07.6013</b>	• •	• •	• •	• •

## Channel connector corner 3-Way - 6 holes

7.14

	Dimensions			Nr. of holes	Packing	Weight (kg/pcs)	Part no. 1	Finish			
	Profile	T	Hole					BL	SG	HG	SS
	Strut 41	4 6	Ø13	6	5	0.34 0.48	<b>07.4014</b> <b>07.6014</b>	• •	• •	• •	• •

## Channel connector corner 3-Way - 8 holes

7.15

	Dimensions			Nr. of holes	Packing	Weight (kg/pcs)	Part no. 1	Finish			
	Profile	T	Hole					BL	SG	HG	SS
	Strut 41	4 6	Ø13	8	20	0.51 0.73	<b>07.4015</b> <b>07.6015</b>	• •	• •	• •	• •

## Channel connector corner 4-Way - 9 holes

7.16

	Dimensions			Nr. of holes	Packing	Weight (kg/pcs)	Part no. 1	Finish			
	Profile	T	Hole					BL	SG	HG	SS
	Strut 41	4 6	Ø13	9	1	0.57 0.81	<b>07.4016</b> <b>07.6016</b>	• •	• •	• •	• •

## Channel connector corner 3-Way Special - 6 holes

7.17

	Dimensions			Nr. of holes	Packing	Weight (kg/pcs)	Part no. 1	Finish			
	Profile	T	Hole					BL	SG	HG	SS
	Strut 41	4 6	Ø13	6	1	0.37 0.53	<b>07.4017</b> <b>07.6017</b>	• •	• •	• •	• •

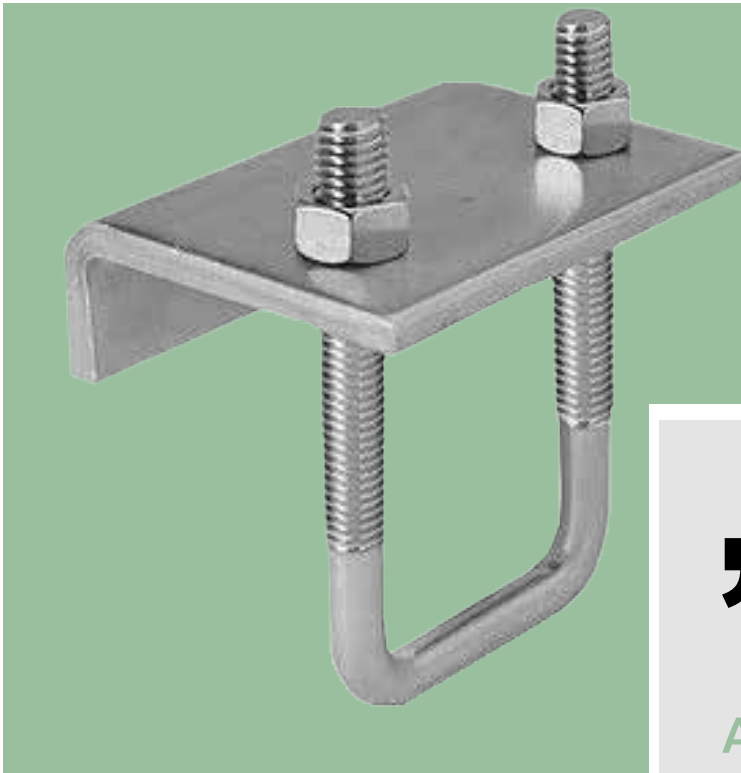

”

**As manufacturer's**  
we can produce in different  
materials, thicknesses,  
lengths;  
with or without finish.

**We can design and produce  
custom solutions!**

**Beam clamps** are designed  
to secure all Strut Channels,  
or threaded rods, to beams  
or supports for the purpose  
of running piping, conduit

or tubing. This section in-  
cludes the most commonly  
used beam clamps, however,  
many others available or re-  
quest.

## Beam clamp - Single channel 41x41 - M10

### 8.1

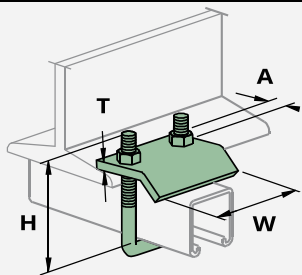

Dimensions				Thread	Packing	Weight (kg/pcs)	Part no. 1	Finish			
W	H	T	A					BL	EG	HG	SS
80	95	6	38	M10	10	0.41	<b>08.1001</b>	•	○	•	○

## Beam clamp - Double channel 41x41 - M10

### 8.2

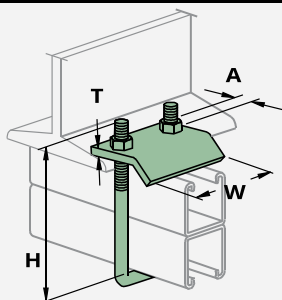

Dimensions				Thread	Packing	Weight (kg/pcs)	Part no. 1	Finish			
W	H	T	A					BL	EG	HG	SS
80	140	6	38	M10	10	0.48	<b>08.1002</b>	•	○	•	○

## Beam clamp - Double channel 41x81 - M10

### 8.3

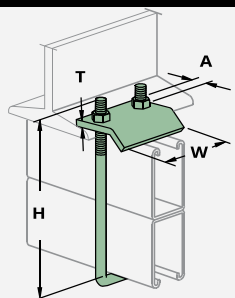

Dimensions				Thread	Packing	Weight (kg/pcs)	Part no. 1	Finish			
W	H	T	A					BL	EG	HG	SS
80	180	6	38	M10	10	0.50	<b>08.1001</b>	•	○	•	○

## Beam clamp - Single channel 41x41 with hook - M10

### 8.4

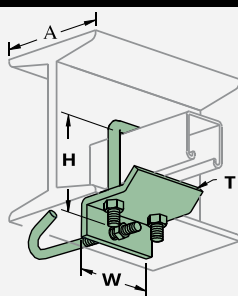

Dimensions				Thread	Packing	Weight (kg/pcs)	Part no. 1	Finish			
W	H	T	A					BL	EG	HG	SS
80	95	6	80-150	M10	10	0.51	<b>08.1001</b>	•	○	•	○

## Beam clamp - Double channel 41x41 with hook - M10

### 8.5

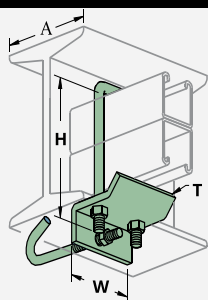

Dimensions				Thread	Packing	Weight (kg/pcs)	Part no. 1	Finish			
W	H	T	A					BL	EG	HG	SS
80	140	6	80-150	M10	10	0.58	<b>08.1001</b>	•	○	•	○

## Beam clamp - Double channel 41x81 with hook - M10

8.6

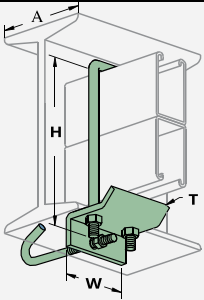

Dimensions				Thread	Packing	Weight (kg/pcs)	Part no. 1	Finish			
W	H	T	A					BL	EG	HG	SS
80	180	6	80-150	M10	10	0.60	08.1001	●	○	●	○

## Double beam clamp - Single channel 41x41 - M10

8.7

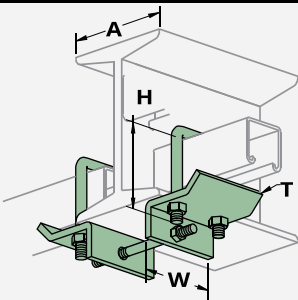

Dimensions				Thread	Packing	Weight (kg/pcs)	Part no. 1	Finish			
W	H	T	A					BL	EG	HG	SS
80	95	6	80-150	M10	5	0.92	08.1001	●	○	●	○

## Double beam clamp - Double channel 41x41 - M10

8.8

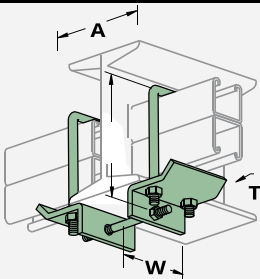

Dimensions				Thread	Packing	Weight (kg/pcs)	Part no. 1	Finish			
W	H	T	A					BL	EG	HG	SS
80	140	6	80-150	M10	5	1.06	08.1001	●	○	●	○

## Double beam clamp - Double channel 41x81 - M10

8.9

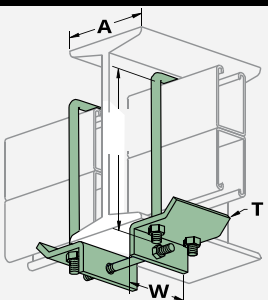

Dimensions				Thread	Packing	Weight (kg/pcs)	Part no. 1	Finish			
W	H	T	A					BL	EG	HG	SS
80	180	6	80-150	M10	5	1.10	08.1001	●	○	●	○

## Beam clamp strut 41

8.10

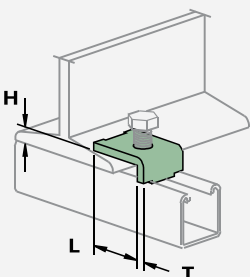

Dimensions			Hole	Packing	Weight (kg/pcs)	Part no. 1	Finish			
L	H	T					BL	EG	HG	SS
43	32	6	Ø13	10	0.12	08.1001	●	○	●	○

The trapeze hanger is a fastening element for trapezoidal sheets and ceilings. It is for fixing sprinkler systems with screw SKS M8x100 in a punched

hole. For fixing other pipes with self-tapping screws or steel blind rivets. Specified shear points allow for ideal adjustment to trapezoidal shape.



”

**As manufacturer's**

we can produce in different materials, thicknesses, lengths; with or without finish...

**We can design and produce custom solutions!**

## Trapeze short 90x90 M10

9.1

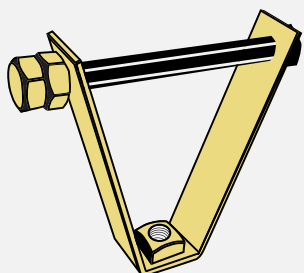

W	Dimensions		Thread	Packing	Weight (kg/pcs)	Part no. 1	Finish			
	H						BL	EG	HG	SS
90	90		M10	25	0.32	09.3010	•	•	•	○

## Trapeze medium 105x90

9.2

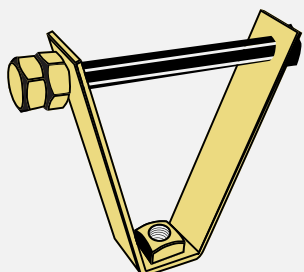

W	Dimensions		Thread	Packing	Weight (kg/pcs)	Part no. 1	Finish			
	H						BL	EG	HG	SS
90	105		M10	25	0.38	09.3011	•	•	•	○
90	105		M12	25	0.41	09.3012	•	•	•	○

## Trapeze high 120x90 M12

9.3

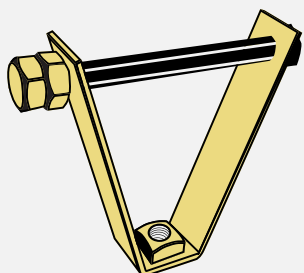

W	Dimensions		Thread	Packing	Weight (kg/pcs)	Part no. 1	Finish			
	H						BL	EG	HG	SS
90	120		M12	25	0.43	09.3013	•	•	•	○

## Mounting plate 120x40x5 M8

9.4

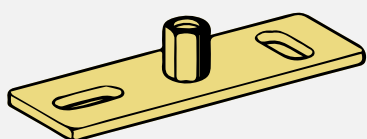

L	Dimensions			Thread	Packing	Weight (kg/pcs)	Part no. 1	Finish			
	W	T						BL	EG	HG	SS
120	40	5		DIN 934	50	0.165	09.5001	•	•	•	○
				DIN 6334		0.17	09.5002	•	•	•	○

## Mounting plate 120x40x5 M10

9.5

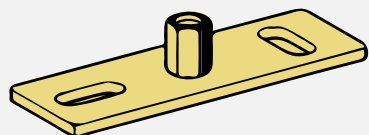

L	Dimensions			Thread	Packing	Weight (kg/pcs)	Part no. 1	Finish			
	W	T						BL	EG	HG	SS
120	40	5		DIN 934 DIN 6334	50	0.175 0.18	<b>09.5003</b> <b>09.5004</b>	•	•	•	○

## Mounting plate 120x40x5 M16

9.6

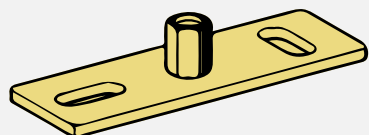

L	Dimensions			Thread	Packing	Weight (kg/pcs)	Part no. 1	Finish			
	W	T						BL	EG	HG	SS
120	40	5		DIN 934 DIN 6334	50	0.2 0.25	<b>09.5005</b> <b>09.5006</b>	•	•	•	○

## Mounting plate 120x40x5 1/2"

9.7

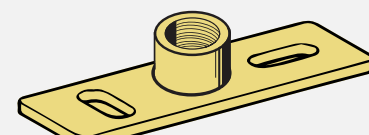

L	Dimensions			Thread	Packing	Weight (kg/pcs)	Part no. 1	Finish			
	W	T						BL	EG	HG	SS
120	40	5		1/2"	50	0.295	<b>09.5007</b>	•	•	•	○

## Mounting plate 120x40x5 1"

9.8

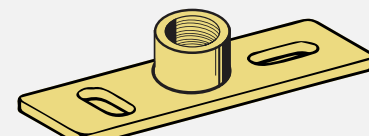

L	Dimensions			Thread	Packing	Weight (kg/pcs)	Part no. 1	Finish			
	W	T						BL	EG	HG	SS
120	40	5		1"	50	0.32	<b>09.5008</b>	•	•	•	○

## Mounting plate 120x45x6 1 1/2"

9.9

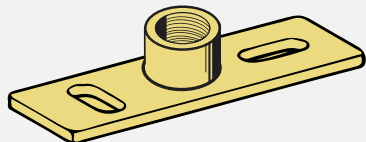

L	Dimensions			Thread	Packing	Weight (kg/pcs)	Part no. 1	Finish			
	W	T						BL	EG	HG	SS
120	45	6		1 1/2"	50	0.39	09.6009	•	•	•	○

## Mounting plate 80x30x3 1/2"

9.10

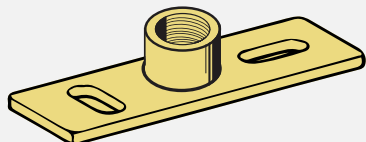

L	Dimensions			Thread	Packing	Weight (kg/pcs)	Part no. 1	Finish			
	W	T						BL	EG	HG	SS
80	30	6		1/2"	50	0.249	09.0314	•	•	•	○

## Mounting plate 80x30x3 M10

9.11

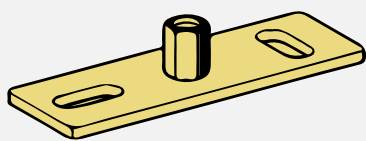

L	Dimensions			Thread	Packing	Weight (kg/pcs)	Part no. 1	Finish			
	W	T						BL	EG	HG	SS
80	30	3		M10	50	0.129	09.0315	•	•	•	○

## Mounting plate 80x30x3 M8-M10

9.12

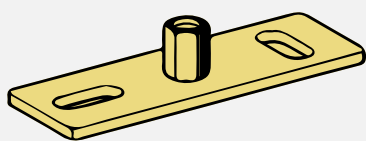

L	Dimensions			Thread	Packing	Weight (kg/pcs)	Part no. 1	Finish			
	W	T						BL	EG	HG	SS
80	30	3		M8-M10	50	0.135	09.0316	•	•	•	○



Prefabricated **modules** regularly increase profit margins and decrease expenses, by realizing maximum quality output and continuity and reduced completion times on site. With our 41x41x2.5 mm channels, all parts fit consistently, providing the maximum number of supports and framing applications with the minimum amount of labour and materials.

#### Conduit Trapeze supports

Trapeze hangers are the most commonly used supporting method in the industry.

#### Assembling

C channels can be cut to specific lengths and bundled as entire assemblies for quick and easy field installation.

”

#### As manufacturer

we can assemble a combination of cantilever arms with brackets including strut-nuts and all requested fixing material as a total package.

**European Strut & Support Manufacturer** offers quality supports for the sprinkler installations, for all kind of industries.

Products include pipe hangers and supports, heavy duty cantilevers CPVC straps, beam clamps, seismic bracing and many more.



”

**As manufacturer's**

we can produce in different materials,  
thicknesses, lengths;  
with or without finish...

**We can design and produce custom solutions!**

## Fixing bracket 50x50x5 2 holes

## 11.1



W	Dimensions		Holes	Packing	Weight (kg/pcs)	Part no. 1	Finish			
	H	T					BL	EG	HG	SS
50	50	5	2	50	0.19	11.5001	•	•	•	•

## Retainer strap 25x2.5x350mm 2 holes

## 11.2

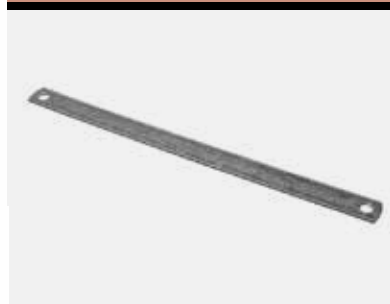

W	Dimensions		Holes	Packing	Weight (kg/pcs)	Part no. 1	Finish			
	L	T					BL	EG	HG	SS
25	350	2.5	2	50	0.14	11.3502	•	•	○	○

## Retainer strap 25x2.5x500mm 2 holes

## 11.3

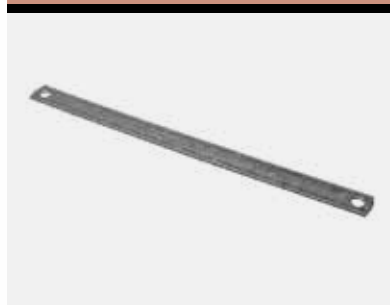

W	Dimensions		Holes	Packing	Weight (kg/pcs)	Part no. 1	Finish			
	L	T					BL	EG	HG	SS
25	500	2.5	2	50	0.2	11.5003	•	•	○	○

## Mounting plate 200x100x6 1"

## 11.4



W	Dimensions		Thread	Packing	Weight (kg/pcs)	Part no. 1	Finish			
	L	T					BL	EG	HG	SS
200	100	6	1"	25	0.327	11.2004	•	•	•	•

## Mounting plate 200x100x6 2"

## 11.5



W	Dimensions		Thread	Packing	Weight (kg/pcs)	Part no. 1	Finish			
	L	T					BL	EG	HG	SS
200	100	6	2"	25	0.33	11.2005	•	•	•	•

Anti-seismic straight and rectangular duct suspension brackets  
Easy height adjustment by using threaded rod and hex nuts.

With a rubber element that prevents transmissions of vibrations.



”

As manufacturer's we can produce in different materials, thicknesses, lengths; with or without finish.

**We can design and produce custom solutions!**

Earth bosses are designed to provide an earth connection point on a steel structure - the earth boss is welded onto steel vessels, tanks and other structures.

**Todebo Suppor Systems** offers a full range of grounding & lightning protection products, manufactured from mild steel or stainless steel with stainless steel fittings.



”

**As manufacturer's**

we can produce in different materials, thicknesses, lengths; with or without finish...

**We can design and produce custom solutions!**

## Earth boss Ø50mm L=50mm

13.1



Ø	Dimensions		Thread	Packing	Weight (kg/pcs)	Part no. 1	Finish			
	L						BL	EG	HG	SS
50	50		M10	1	0.8	13.5001	•	•	○	•

## Rod Ø16mm L=1200mm

13.2



Ø	Dimensions		Thread	Packing	Weight (kg/pcs)	Part no. 1	Finish			
	L						BL	EG	HG	SS
16	1200		M10	5	1.8	13.1202	•	•	○	•

## Rod Ø16mm L=1500mm

13.3



Ø	Dimensions		Thread	Packing	Weight (kg/pcs)	Part no. 1	Finish			
	L						BL	EG	HG	SS
16	1500		M10	5	2.25	13.1503	•	•	○	•



Instrument stands and supports are used to mount various control devices in an industrial setting. TSS manufactures instrument stands using welded pipe or structural channel, 8mm to 12mm thick base plates with round or slotted holes.

”

### **As manufacturer's**

we can produce in different materials, thicknesses, lengths; with or without finish.

**We can design and produce custom solutions!**



## Instrument support dual Ø60.3 - 1500/400mm

14.1



W	Dimensions		Pipe	Packing	Weight (kg/pcs)	Part no. 1	Finish			
	H						BL	EG	HG	SS
400	1500		60.3	1	20.5	14.1502	•	•	•	•

## Instrument support single Ø60.3 - H=1600mm

14.2



W	Dimensions		Pipe	Packing	Weight (kg/pcs)	Part no. 1	Finish			
	H						BL	EG	HG	SS
300	1600		60.3	1	16.5	14.1601	•	•	•	•

## Wall instrument support 60.3 - 200x300

14.3



W	Dimensions		Pipe	Packing	Weight (kg/pcs)	Part no. 1	Finish			
	H						BL	EG	HG	SS
200	300		60.3	1	0.68	14.1502	•	•	•	•

Structural Bases Frames are specifically designed and engineered to support HVAC and mechanical equipment, electric motors, pumps, compressors and combinations thereof, requiring a supplemental mounting frame.

We can design frames **for you** or make the frame according to your drawing with different surface treatments.

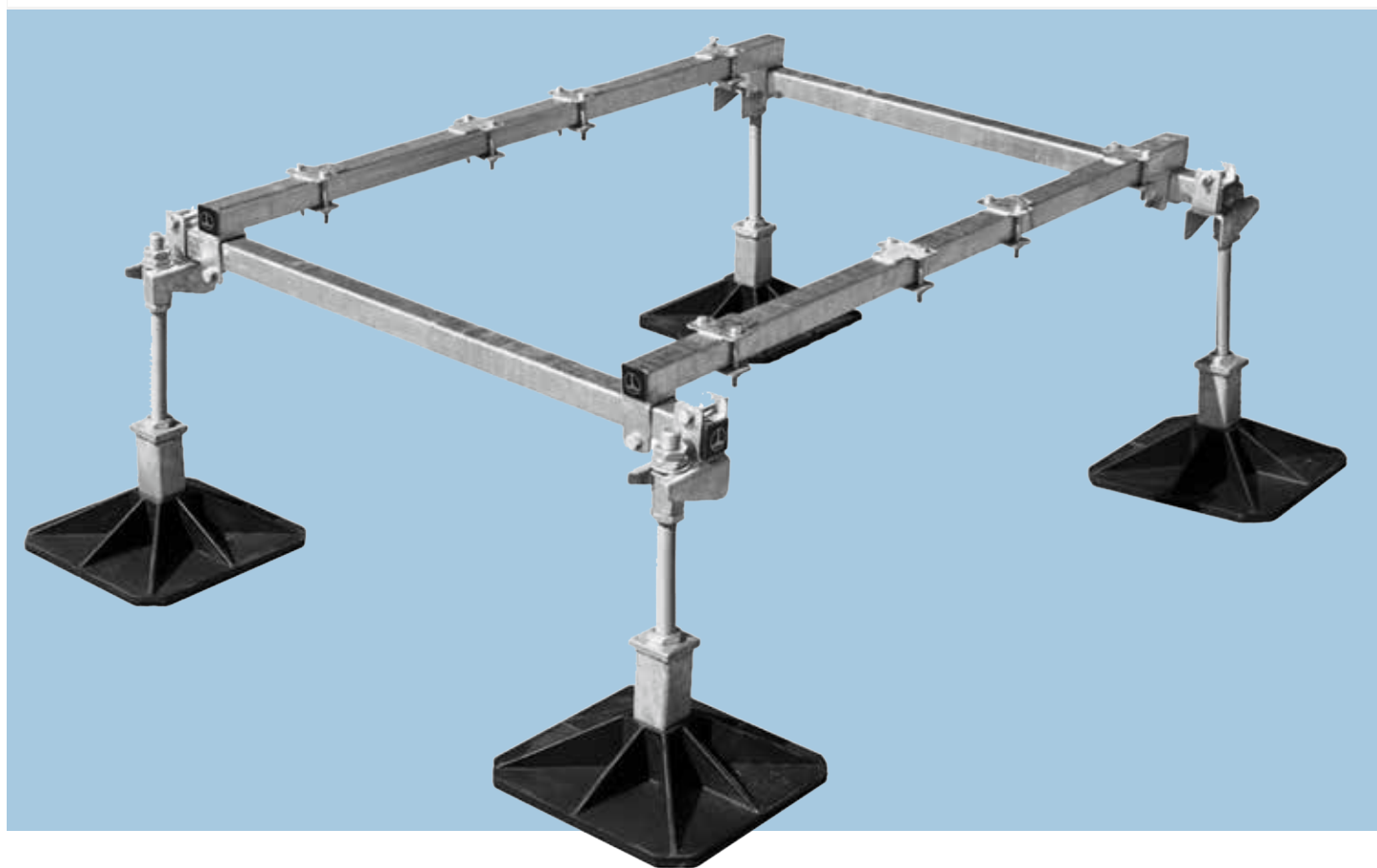

”

**As manufacturer's**

we can produce in different materials, thicknesses, lengths; with or without finish...

**We can design and produce custom solutions!**

...for fixings and suspensions that **cannot** be carried out by the standard



**As manufacturer's** we can produce in different materials, thicknesses, lengths; with or without finish.  
**We can design and produce custom solutions!**

”

For fixings and suspensions that cannot be carried out by the standard modular Strut system or other systems, we can engineer a solution and custom made make it for you. All kind of Cantilever Arm, ceiling and roof supports and fixing brackets.



”

As manufacturer's we can produce in different materials, thicknesses, lengths; with or without finish.

**We can design and produce custom solutions!**

## HEALTH - SAFETY - ENVIRONMENT - QUALITY

The responsible use of nature and its resources, the protection of human health and the environment are basic principles of our business operations.

We are aware of our responsibility towards our colleagues, suppliers and everyone involved in the production process, as well as towards the environment whose resources we responsibly use.

Through the production activity, we continuously take care of the health, safety, environment and quality (HSEQ).

The success in the area of HSEQ and the fulfilment of the most demanding industry standards, we provide by applying defined rules and procedures during the operation in everyday work.

The reputation in the field of HSEQ leaves positive effect on the entire organization, therefore we constantly strive to maintain the following objectives.

- **The realization of long-term employment** : zero accidents at work, increased safety awareness and prevention of injuries and absences.
- **Creating and preserving the reputation of a good employer.**
- Recognition, acceptance and **minimization of the risk.**
- **Preservation of the environment:** Minimization of the negative impact on and preventing damage to the environment.
- **Fulfillment of the demands, desires and expectations** of our clients and subcontractors.

Each employee has specific obligations in the execution of his tasks. This type of business operation is achieved in the following ways:

- We have **professional** people to carry out activities.
- We use **certified HSEQ** Management System.
- We **set goals** which are regularly assessed, evaluated and adjusted where necessary.
- We strive to ensure that the appropriate means of **protection and safety at work** are available for the protection of people, materials and the environment as much as possible.
- We remove and/or **reduce the risk** in carrying out our activities, in order to not expose our employees and other associates to industrial hazards.
- We continuously search for methods and/or auxiliary means which have the **smallest possible negative effect on the environment**.
- We freely talk about our **achievements in the field of HSEQ**.
- We **create an environment** in which our employees and other associates are committed to achieving the objectives in the area of HSEQ.

We are taking care of our suppliers, customers and our employees, simultaneously with the environment protection. We have a **zero-waste policy** (ISO 14001) and we believe in recycling.



ISO 9001:2015   ISO 14001:2015   OHSAS 18001:2015   EN ISO 3834-2   EN 1090 EX2

Various certificates are available on request.

## MATERIALS

### Spring Steel

Spring steel is an alloy of iron and carbon. Spring steel alloys can be easily formed into complex shapes, and then heat-treated to greatly increase strength.

ESM spring steel fasteners are heat treated in modern shaker hearth furnaces. Parts are conveyed directly from a high temperature furnace to a quench tank, through a cleaning cycle and into a tempering furnace. Precision controls maintain heat treat operations within established limits developed for Todebo fasteners.

### Steel

Steel is an alloy of iron and other elements, the most common being carbon. Varying the amount of alloying elements and the form of their presence in the steel controls qualities such as the hardness, ductility, tensile strength and corrosion resistance of the resulting steel.

### Stainless Steel

Stainless Steel is an alloy of iron and carbon that is more resistant to rust, staining and corrosion than regular steel.

### Stainless Steel 304

The most familiar stainless steel is Type 304, containing 18-20% chromium and 8-10% nickel.

Also referred to as 'A2'.

**Stainless 304 is not suitable** for use in swimming pools.

### Stainless Spring Steel 301

A highly ductile steel used on formed products that hardens rapidly during mechanical working. Stainless 301 has better wear resistance and fatigue strength than Stainless 304 or standard Spring Steel.

**Stainless 301 is not suitable** for use in swimming pools quench tank, through a cleaning cycle and into a tempering furnace. Precision controls maintain heat treat operations within established limits developed for ESM fasteners.

### Stainless Steel 316

The second most common stainless steel is 316, also called marine grade stainless, used primarily for its increased resistance to corrosion.

Also referred to as 'A4'.

**Stainless 316 is not suitable** for use in swimming pools.

### Cast iron

Cast Iron is a commercial alloy of iron, carbon and silicon that is cast in a mold.

This results in a product that is hard, brittle, non-malleable and incapable of being hammer-welded but more easily fusible than steel.

## SURFACE TREATMENT

### Painted

Paint is any liquid composition, which after application to a surface in a thin layer, is converted to a solid film. It is most commonly used to protect, color or provide texture to objects.

### Pre-galvanized Zinc (PG)

EN 10142/10147 / ASTM A653/A653M  
Pre-galvanized zinc is produced by continuously rolling steel coils or sheets through molten zinc at the mills. The coils or sheets are slit to size and fabricated by forming, shearing or punching to produce the finished product. During fabrication cut edges are not generally zinc coated; however, the zinc near the uncoated metal becomes a sacrificial anode to protect the bare areas. Pre-galvanized zinc products are generally recommended for indoor use on mildly corrosive environments.

### Electro-galvanized (EG)

EN 12329 / ASTM B633  
This corrosion protective coating is applied after the fabrication of steel or malleable iron parts and uses an electrolytic plating process that deposits zinc. A second passivation coating of chromate is then applied for additional protection. Zinc electroplate products are recommended for indoor and mildly corrosive applications.

### Hot Dip Galvanized Zinc (HD)

EN ISO 1461 / ASTM A123  
After a product has finished its fabrication process, it is dipped into a bath of molten zinc. The zinc completely coats all edges and surfaces. Zinc thickness is controlled by the time the part is immersed in the molten zinc bath. Hot dip galvanized zinc products are recommended for indoor, outdoor and mildly corrosive environments.

### Powder coating

Powder coating is a process by which electrically charged metal is coated with powder of the opposite polarity. This is achieved with an electrostatic dusting gun. Electricity helps to attract the dust where it does not appear, and to deduct where it was already applied. Due to the polyurethane composition the powder functions as an insulator. During further applications any extra layers drop off the covered part. This ensures an evenly distributed layer. This is then converted into an even layer of plastic during the polymerization at 180 °C. Powder coating is available in all RAL colours.

**MADE IN  
EUROPE**



[www.esm.rs](http://www.esm.rs)



[office@esm.rs](mailto:office@esm.rs)



+381(0)22 671 543



22000 Sremska Mitrovica ; Rumski Drum 79

